

LAUFEN CLEANET NAVIA

OPERATING MANUAL



**+1 YEAR'S
GUARANTEE**

Register your shower toilet now!
www.laufen-cleanet.com



LAUFEN

CONTENTS

1	SAFETY AND WARNING NOTICES	3
2	INTRODUCTION	4
2.1	Notices	4
2.2	Shower toilet: LED indicator light	4
3	OVERVIEW OF YOUR NAVIA SHOWER TOILET	5
3.1	Shower toilet	5
3.2	Controller with rotary button	6
3.3	Laufen App	6
4	OPERATING THE SHOWER TOILET	7
4.1	Rear shower	8
4.1.1	Jet intensity	8
4.1.2	Shower jet position	8
4.1.3	Oscillation	8
4.2	Lady shower	9
4.2.1	Jet intensity	9
4.2.2	Shower jet position	9
4.2.3	Oscillation	9
4.3	Selecting special functions using the app	10
4.3.1	Appliance flushing	10
4.3.2	Configuring the basic profile	10
4.3.3	Water hardness	10
4.3.4	Heater settings	10
5	MAINTENANCE AND CLEANING	11
5.1	Cleaning the seat and cover unit	11
5.2	Cleaning the ceramic surface	11
5.3	Cleaning plastic surfaces and metal components	11
5.4	Suitable cleaning agents and equipment, cleaning tips	12
5.5	Unsuitable cleaning agents and equipment	12
5.6	Ordering consumables	12
5.7	Descaling	13
5.8	Changing the nozzle	14
5.9	Changing the cover ring	15
6	TROUBLESHOOTING	16
6.1	Messages and faults	16
7	DISPOSAL AND ENVIRONMENT	17
8	TECHNICAL DATA CLEANET NAVIA	18
9	LEGAL NOTICE	19

1 SAFETY AND WARNING NOTICES

Intended use

The Laufen shower toilet is designed to wash the rear area and also the female intimate area with the lady shower. Any other kind of use is not permitted. Glowing cigarettes or other burning objects must not be thrown into the WC bowl. Laufen shall not accept liability for damage that occurs as a result of connecting the appliance incorrectly, misuse, or inappropriate use.

Improper operation includes initiating the shower procedure without anyone sitting on the shower toilet. This may cause water damage in the surrounding area.

Persons with physical, sensory or mental disabilities as well as persons who are completely unfamiliar with the appliance (especially children) may only use the shower toilet under the supervision or instruction of a responsible person.

Warning notices/precautions (your safety)

Never operate a defective appliance.

Always use tap water to operate your Laufen shower toilet. Do not use rainwater, grey water, or demineralised water.

Check all functions regularly to ensure they work normally. Should you have any suspicion that the appliance is faulty, disconnect it immediately from the power supply and contact Laufen customer services.

Do not attempt to open or repair the appliance yourself. Do not install any additional components or make any modifications. The appliance contains live components. Opening the appliance can be extremely dangerous!

Unprofessional repairs can cause dangerous accidents, malfunctions, or damage to the appliance and installation. Repairs must therefore always be performed by trained and authorised personnel using original spare parts and accessories.

Do not allow children to clean and maintain the appliance without supervision. Installation may only be carried out using new hose sets. Old hose sets must not be reused.

Only original electrical connection, water inlet and replacement part material may be used. For care and cleaning and also for descaling, use only original Laufen or Laufen-recommended products. We do not accept liability for the use of other products.

Visit www.laufen-cleanet.com to view the Declaration of Conformity

2 INTRODUCTION

2.1 NOTICIES



Menu



Info



Shower settings





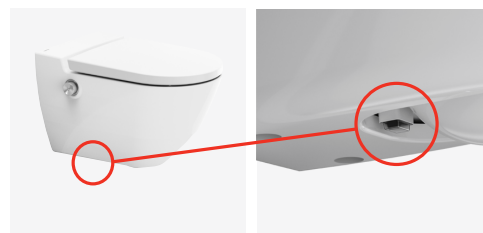

Help

2.2 SHOWER TOILET: LED INDICATOR LIGHT

The LED indicator light is located on the underside of the appliance. It provides information about required maintenance or possible malfunctions on your shower toilet.



LED indicator light

	LED indicator light	Information	Description
No indication		Normal operation	Everything functioning correctly.
Steady red		Care notice	Please descale your shower toilet. i For further information and descriptions on the notice, see section 5.7, Descaling.
Red, flashing		Care programme active	Descaling is active when the red LED indicator light is flashing. i For further information and descriptions, see section 5.7, Descaling.
Red, flashing fast		Fault indication	Please contact us at www.laufen-cleanet.com i For further information and descriptions of the problem, see section 6, Troubleshooting.

3 OVERVIEW OF YOUR NAVIA SHOWER TOILET

3.1 SHOWER TOILET

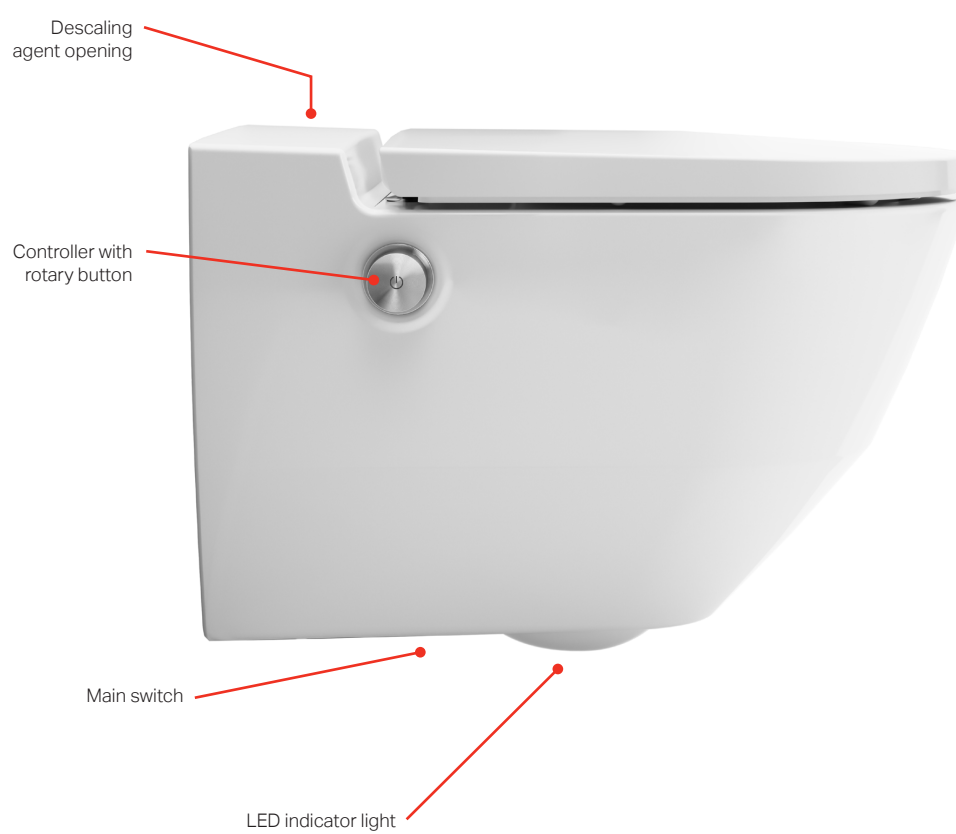

3 OVERVIEW OF YOUR NAVIA SHOWER TOILET

3.2 CONTROLLER WITH ROTARY BUTTON

You can operate the Laufen shower toilet easily by turning and pressing the controller located on the right. The following functions can be activated using the controller:

- Rear shower
- Lady shower
- Jet intensity
- Shower jet position
- Oscillation

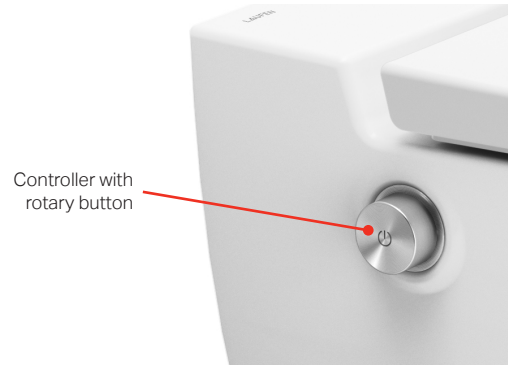

3.3 LAUFEN APP

Your shower toilet can be operated easily with the Laufen app for iPhone and Android, including useful special functions. For further descriptions, see section 4.2. An active internet connection is not required.

Main menu

- Rear shower
- Lady shower
- Jet intensity
- Shower jet position
- Water temperature
- Oscillation
- Basic profile management
- Appliance connection

Maintenance menu

- Descaling programme
- Appliance flushing
- Temperature settings and ECO mode
- Water hardness settings
- Language and country settings
- Appliance information
- Ordering consumables

Info menu

- Appliance information
- List of serial numbers
- Downloading instructions

Service menu

- Recording service messages
- First aid, questions and answers
- Explanation of the icons and symbols

Install the free app directly from the App Store or Google Play.

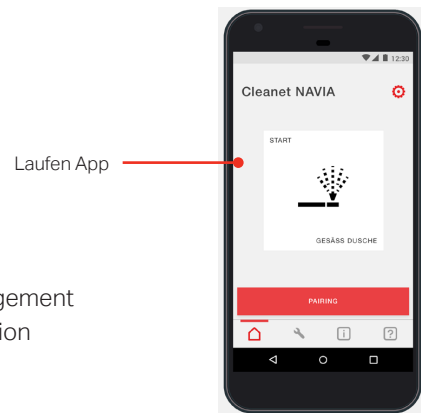

4 OPERATING THE SHOWER TOILET

Your Laufen shower toilet can be operated using either the controller with rotary button or via the Laufen app.

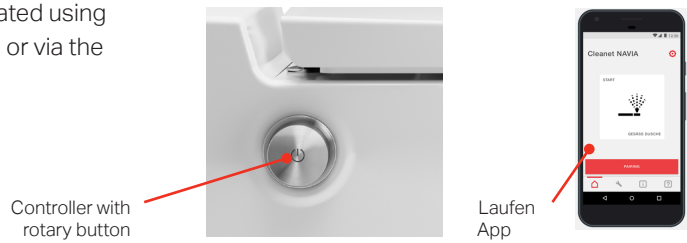

Rear shower			
Lady shower			
Jet intensity minus / plus			
Shower arm forwards			
Shower arm back			
Oscillation			
Stop	STOP 		

4 OPERATING THE SHOWER TOILET

4.1 REAR SHOWER



While you are sitting on the shower toilet, briefly press the controller on the right side to start the rear shower. If you need to stop the shower prematurely, press the controller again.



If you wish to shower again, press the controller while the shower arm is retracting at the end of the first showering procedure.



The factory setting for the heating is always "switched on" (see section 4.2.3). If you shower repeatedly, the water will gradually become cooler.



The shower duration is factory preset to 25 seconds.



Improper operation includes initiating the shower procedure without anyone sitting on the shower toilet. This may cause water damage in the surrounding area.

4.1.1 JET INTENSITY

The jet intensity can be adjusted to one of 7 settings. You can adjust the jet intensity while showering by turning the controller.

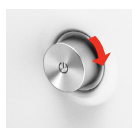

Turn the controller forwards to increase the jet intensity.



Turn the controller backwards to reduce the jet intensity.



The jet intensity is factory preset to 4 out of a possible 7.

4.1.2 SHOWER JET POSITION

The position of the shower jet can be adjusted to one of 7 settings. While showering, you can simultaneously press and turn the controller back or forwards. The shower jet follows the direction of rotation.

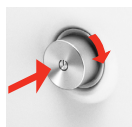

Press the controller and simultaneously turn it forwards to move the shower jet forwards.



Press the controller and simultaneously turn it back to move the shower jet back.



The jet position is factory preset to 4 out of a possible 7.

4.1.3 OSCILLATION

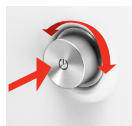

Press the controller and turn it quickly forwards and backwards twice to generate an automatic forwards and backwards movement of the shower jet.

4 OPERATING THE SHOWER TOILET

4.2 LADY SHOWER



When seated on the shower toilet, press the rotary button on the right-hand side and hold it down for approx. 2 seconds to start the lady shower. To stop the Lady shower prematurely, simply press the button again.



If you want to shower a second time, press the rotary button again and hold it (approx. 2 seconds), while the shower arm retracts after the first shower process.

4.2.1 JET INTENSITY

While the lady shower is active, you can select one of 7 jet intensity settings. On the whole, the jet intensity settings are more gentle than the rear shower settings.

OPERATION WHILE USING THE SHOWER TOILET

You can adjust the jet intensity during showering by turning the rotary button.



"Turn the rotary button forwards to increase the jet intensity."

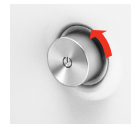

"Turn the rotary button back to reduce the jet intensity."

4.2.2 SHOWER JET POSITION

While the lady shower is active, you can adjust the shower jet to one of 7 positions.

OPERATION WHILE USING THE SHOWER TOILET

While showering, you can simultaneously press and turn the rotary button back or forwards. The shower jet follows the direction of rotation.



"Press and turn the rotary button forwards simultaneously to move the shower jet forwards."



"Press and turn the rotary button back simultaneously to move the shower jet back."

4.2.3 OSCILLATION



Press the controller and turn it quickly forwards and backwards twice to generate an automatic forwards and backwards movement of the shower jet.

4 OPERATING THE SHOWER TOILET

4.3 SELECTING SPECIAL FUNCTIONS USING THE APP

The Laufen app gives you access to practical special functions which you can only select via your smartphone.

4.3.1 APPLIANCE FLUSHING



The appliance flushing feature allows you to flush out your shower toilet completely to clean it and to supply it with fresh water. It is recommended that appliance flushing be carried out particularly after longer periods of inactivity (e.g., after holidays).

4.3.2 CONFIGURING THE BASIC PROFILE



The Laufen app allows you to save a personal user profile. You can use this to individually set the desired jet intensity and position.

4.3.3 WATER HARDNESS



The Laufen app allows you to store the hardness of your mains water in order to ensure an optimum interval for the automatic descaling programme.

There are various ways of measuring the water hardness:

- Ask your water supply company. You will usually find this information on your water bill.
- Factory setting: 25–35 °fH

4.3.4 HEATER SETTINGS



You can adjust the heater settings using the app. The factory setting for the heater is always ON.

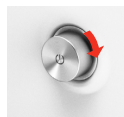

	Description
ON	The boiler heater is permanently switched on and produces and maintains the desired water temperature.
ECO	The boiler heater switches on as soon as you indicate your presence to the appliance by briefly turning the controller. Warm water is available after a heating time of approx. 2 minutes.
OFF	The boiler heater is switched off permanently. Only cold water is available. Which means energy consumption is minimised.

5 MAINTENANCE AND CLEANING

5.1

CLEANING THE SEAT AND COVER UNIT

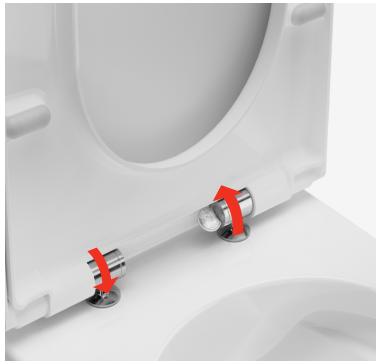

The seat and cover are integrated in a single unit because of the lowering system.

The seat and cover unit can be removed to make the shower toilet easier to clean. Simply lift the seat and cover to a vertical position, use a coin to release the locking screws and pull the seat and cover from the hinge at both sides. Clean the seat and cover in a bathtub for example. You can also use a mild diluted liquid detergent. After cleaning, reassemble the seat and cover and insert in the hinge in a vertical position and tighten. You will find further cleaning and care hints in the separate care instructions.

5.2

CLEANING THE CERAMIC SURFACE

Aggressive cleaning products are no longer required due to the specially glazed ceramic surface. Clean the ceramic surface using a standard all-purpose detergent diluted with water. Use a sponge with a soft, non-scratch surface or alternatively a microfibre cloth.



Do not use aggressive or abrasive agents, tools or instruments to clean the appliance.

5.3

CLEANING PLASTIC SURFACES AND METAL COMPONENTS

Plastic surfaces

- Seat and cover unit
- Cover ring and nozzle
- Descaling

Metal components

- Controller and metal cover
- Hinge
- Shower arm

Wipe over these components with a soft, damp cloth and an extremely mild, diluted cleaning detergent, if required. Then dry the components using a soft cloth.



Do not use aggressive or abrasive agents, tools or instruments to clean the appliance.

5 MAINTENANCE AND CLEANING

5.4 SUITABLE CLEANING AGENTS AND EQUIPMENT, CLEANING TIPS

- Slightly acidic cleaning agents such as vinegar, all-purpose, glass, bathroom or limescale cleaner
- Foam cleaning agents
- Dilute cleaning agent with water
- Always use liquid cleaning agents
- Ensure the cleaning agent is dermatologically compatible
- Normal toilet brushes
- Soft, non-abrasive sponges
- Microfibre cloths

5.5 UNSUITABLE CLEANING AGENTS AND EQUIPMENT

- Abrasive and powdery cleaning or scouring agents such as scouring powder, sand and scouring cream
- Strong, corrosive products such as steel or fitting cleaners, aggressive pipe or drain cleaners, alkaline solutions, bleach and mould remover
- Chlorinated cleaning agents
- Cleaning agents that irritate the eyes and skin
- Hard and abrasive sponges
- Steel wool, pan scourers, etc.
- Pointed objects such as scrapers designed for mechanical cleaning

5.6 ORDERING CONSUMABLES

You can order the following consumables on www.laufen-cleanet.com or from specialist dealers.

	Article no.
6 descaling tablets for 2 applications	8.9260.4.000.000.1
Nozzle and cover ring	8.9260.6.000.000.1
Rotary button	8.9260.8.000.000.1
Cover for descaling opening	8.9260.7.000.000.1

Subject to modifications

5 MAINTENANCE AND CLEANING

5.7 DESCALING

The Laufen shower toilet incorporates an integral descaling program for descaling water-carrying components. Your appliance detects the need for descaling and informs you (red LED indicator light) accordingly. When the descaling message appears, you can continue using the shower toilet in the usual way until descaling is actually performed. Carry out descaling within a few days of receiving the message. The descaling programme takes around 75 minutes (LED indicator light flashes red).

The shower toilet builds up deposits of limescale over time. The amount of limescale depends on the hardness of the water, the temperature setting, and the frequency of use of the shower toilet.



It is not possible to interrupt the descaling program once it has started. The shower toilet functions are disabled during the cycle. However, the appliance can be used as a normal WC without shower function.



Please note that the use of unsuitable descaling agents can damage the appliance and leave residues in the water. Guarantee and liability claims arising from damage of this nature are expressly rejected.



Descaling signal

The LED indicator light on the shower toilet shows red.

Open the cover on the right hand side of the bowl by pressing on it.



Put 3 genuine Laufen descaling agent tabs into the opening and click the cover back in. The descaling programme will be started automatically by the shower toilet.

You can obtain the necessary descaling agent from Laufen. It is matched to the descaling programme of your appliance. Please always use genuine Laufen descaling agent.

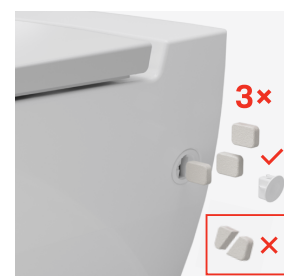

At the end of the descaling cycle, the shower toilet and all its functions are ready to use again.



Please note that failing to initiate the recommended descaling cycle can result in damage to the appliance. Guarantee and liability claims arising from damage of this nature are expressly rejected.

	Article no.
Descaling agent	8.9260.4.000.000.1

Subject to modifications

5 MAINTENANCE AND CLEANING

5.8 CHANGING THE NOZZLE

The shower arm can be extended to clean or replace the nozzle.



Press the controller while simultaneously turning it forwards, to move the shower arm forwards.

Carefully pull off the nozzle.

Clean the nozzle and descale it using commercially available descaling agent such as cleaning vinegar.



All seals on the nozzle must always be greased after cleaning.

If you would prefer to replace the nozzle, replacement nozzles can be purchased from Laufen or specialist dealers.



Carefully attach the cleaned or new nozzle.

Press the controller while simultaneously turning it backwards, to move the shower arm backwards.



Article no.

Nozzle and cover ring

8.9260.6.000.000.1

Subject to modifications

5 MAINTENANCE AND CLEANING

5.9 CHANGING THE COVER RING

If the cover ring becomes covered in limescale or scratched, it can be replaced with a new one. Replacement cover rings can be purchased from Laufen or specialist dealers.

You will require a special tool to replace the cover ring. The tool is supplied with the new cover ring.



Attach the special tool to the bottom edge of the cover ring. There is an opening for the tool located there.

Gently push down the tool until the cover ring lifts out of the snap retainer. Use your other hand to prevent the cover ring from falling. Lift out the cover ring completely and remove it.



Insert the top edge of the new cover ring and push until it clicks into place. Make sure that the tool opening is pointing downwards.

	Article no.
Nozzle and cover ring	8.9260.6.000.000.1

Subject to modifications

6 TROUBLESHOOTING



Electric shock!
Risk of death!

- Never open the appliance to perform repairs yourself.
- Contact Laufen customer services.

6.1 MESSAGES AND FAULTS

Laufen customer services

If faults occur and cannot be rectified using the information in the operating manual, please contact Laufen customer services.

www.laufen-cleanet.com

Messages and faults during operation	Possible causes	Remedy	Section
Does not function	Main switch is off.	Switch on the main switch located under the appliance on the left.	3.1
	General problem with the appliance	Switch off the main switch under the appliance, wait approximately 1 minute then switch it on again.	
	Power supply is interrupted.	Have the power supply checked by a qualified electrician.	
Controller does not work.	Controller is faulty.	Please contact Laufen customer services.	
Water temperature is low.	Heater is deactivated.	 Press "General settings" in the app and set economy mode to ECO or ON.	
	General problem with the appliance	Switch off the main switch under the appliance, wait approximately 1 minute then switch it on again.	
Jet is weak or no water emerges.	Intensity setting of shower jet too low.	Increase the intensity of the shower jet using the Laufen app or turn the controller forwards during the showering procedure. Save the setting in the basic profile using the app.	4.1.1
	Nozzle is covered in limescale or blocked.	Initiate a descaling cycle on the shower toilet. Descal the nozzle or replace it.	5.7 5.8
	Rear shower used too frequently in succession with a high jet intensity.	Please wait at least ten minutes until the rear shower can be used normally again.	
Shower arm does not move back.	Shower toilet is faulty.	Switch off the main switch under the appliance, wait approximately 1 minute then switch it on again. Please contact Laufen customer services if there is no response.	
Lowering system for the seat and cover unit does not function.	Damper is faulty.	Please contact Laufen customer services.	
Red LED indicator light is permanently illuminated.	Carry out descaling.	Insert three Laufen descaling agent tabs into the opening on the right hand side of the bowl.	
Red LED indicator light flashes quickly.	A fault has occurred on the shower toilet.	Switch off the main switch under the appliance, wait approximately 1 minute then switch it on again. Please contact Laufen customer services if there is no response.	

7 DISPOSAL AND ENVIRONMENT



The Laufen shower toilet complies with the requirements of EU Directive "Restriction of Hazardous Substances" (2002/95/EC). It is largely free of hazardous substances such as lead, cadmium, mercury, and chromium VI.

Correct disposal of old appliances

Waste electrical equipment often contains materials that are still usable. At the same time, however, they also contain many hazardous substances that guarantee the operational reliability and safety of the equipment. Incorrect handling and disposal of these substances poses a hazard to humans and the environment.



The symbol on the type plate of your shower toilet indicates that disposal of the appliance with the household waste is not permitted. Please dispose of used batteries correctly. Do not dispose of batteries with the household waste.

Please contact the relevant collection point for returning and recycling electrical equipment in your area.

Store your old appliance in a childproof location until it is transported for disposal.

The plastic parts are marked with internationally standardised symbols to ensure that plastic waste is separated according to type. As a result, your old appliance can be recycled in an environmentally compatible manner.

8 TECHNICAL DATA CLEANET NAVIA

Rated voltage	230 V (AC)
Mains frequency	50 Hz
Power consumption during operation (max.)	1 150 W
Protection level	IPX4
Protection class	I
Water flow pressure range	0.1 to 1 MPa or 1 to 10 bar
Seat and cover load (max.)	150 kg
Storage temperature range	1 to +60 °C
Operating temperature range	+5 to +40 °C
Number of shower pressure settings	7
Number of shower temperature levels	7

Units

V = volt, Hz = hertz, W = watt, m = metre, MPa = megapascal, bar = bar, kg = kilogram, °C = degrees Celsius, s = second

Subject to modifications

The Cleanet Navia shower toilet complies with the requirements of:

- EU Directive 2014 / 35 / EU (Low-Voltage Directive)
- EU Directive 2014 / 30 / EU (EMC, electromagnetic compatibility)
- EU Directive 2014 / 53 / EU (Radio Equipment Directive)
- EU Directive 2011 / 65 / EU (RoHS)
- EN 1717 / 13077

9 LEGAL NOTICE

This manual contains important information on the intended use, correct operation and proper maintenance of the appliance.

Users must understand and comply with the instructions in this operating manual in order to ensure both hazard-free use of the appliance as well as maximum safety during operation and maintenance.

It is not possible to include every conceivable application and type of misuse in this operating manual.

We would also like to draw attention to the following: The content of this manual neither forms part of an earlier or existing agreement, commitment or legal relationship, nor does it amend an existing agreement, commitment or legal relationship. Any obligation on the part of Laufen originates from the respective warranty conditions, which also include the complete and decisive warranty obligation of Laufen. The information provided in these operating instructions represents neither an extension nor a restriction of the claims from the warranty conditions.

This manual is protected by copyright. Copies and / or translations into different languages are only permitted after obtaining prior written permission from Laufen.

WWW.LAUFEN-CLEANET.COM